

# EUREKA TOWNSHIP

## DRIVEWAY OR APPROACH PERMIT INSTRUCTIONS

The following is a summary of the Driveway and Field Approach requirements. It is the responsibility of the applicant to read the complete cited Ordinances noted below.

### Ordinances to review:

Ordinance § 126.2 (D) Fees and escrow amounts established.

Ordinance § 198-2.1 (A-H) Driveways.

Ordinance § 198-3 (A-C) Defining Public Right-of-way.

Ordinance § 198-12 (A-D) Approaches and headwalls.

Ordinance § 235 & 235-5 Water Resources Management / Stormwater management.

Ordinance § 240-9A Legal Description of a Lot.

Ordinance § 240-9A Shared Driveway.

Ordinance § 240-13 Driveways/access to public right-of-way.

Definitions: **Ordinance 198-2.1 (A-H) Driveways.**

### DRIVEWAY

A road giving access from a Township Road, private road or cartway to one or more dwelling units or agricultural buildings located or to be constructed on adjacent lands.

### FIELD APPROACH

An access route from a public road to an adjacent field or pasture.

**Note:** If your Driveway or Field Approach enter onto a county road you will need to contact Dakota County for a permit application.

### General Requirements check list:

- Complete Driveway / Approach Permit Application (See Attached)
- Pay Application fee **Ordinance § 126.2 (D)**
  - Driveway or approach permit: \$100.
- Provide Proof of ownership:
  - Parcel ID **Ordinance § 240.9A** will be verified by the Town Clerk; conflicts must be resolved with a proper deed.
- County permit or letter of exemption if located in the Dakota County Shoreland Zoning
- Provide one (1) copy of the following:
  - Sample Site Plan Illustration

SAMPLE SITE PLAN: (NOTE: Distances should be in relation to the proposed building or structure)

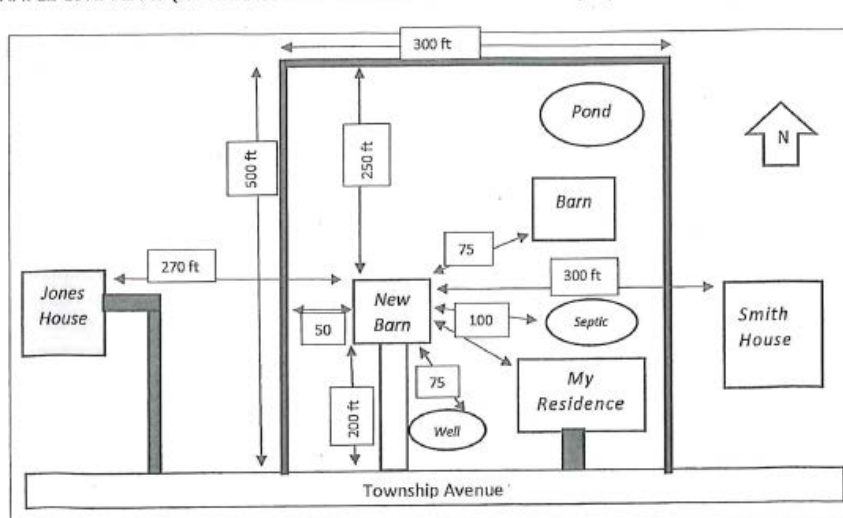

# EUREKA TOWNSHIP

## DRIVEWAY OR APPROACH PERMIT INSTRUCTIONS

- Location and distances to all other structures on the lot and adjoining lots.
- Location and distance to well, drainage and sewage systems.
- Location and dimensions of the proposed driveway and/or approach **Ordinance § 198-2.1 (A-H)**
  - **§ 198-2.1 (C,8)** Applicant must locate the driveway or field approach at least 10 feet from the property line or as necessary to provide adequate drainage onto the parcel the driveway serves.
  - **§ 198-2.1 (C,9)** Applicant must locate the driveway or field approach at least 300 feet from the intersection of any two or more public roads

The parcel on which a dwelling unit is located shall have at least **33 feet** of frontage along a public road. Landlocked lots may meet access requirements as specified in **Ordinances § 240-13 and § 198-3.**

Culverts are the responsibility of the applicant. Size and placement must be approved by the Town Board designated Road Supervisor before a permit is issued. **Ordinance 198-12 B**